

# Coach Me Fit

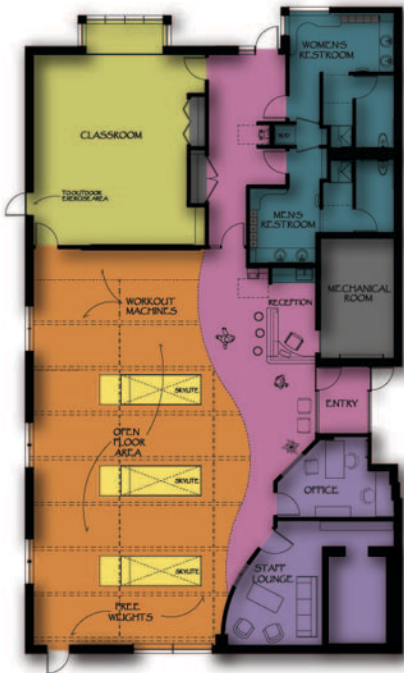

Project Type	Adaptive Reuse
Project Size	4,120 SF
Total Cost / Sf	\$58/SF
Dates of Construction	June - December 2005
Owner	Lindsay Bogdasarian
A/E	Sunstructures Architects
General Contractor	JS Vlg Construction Co.
Mechanical Contractor	Robertson Morrison Inc.
Electrical Contractor	Towler Electrical Services

This personal training center reuses an existing 4000 SF bank building. A large area of lay-in ceiling was removed to expose the structure above, creating a greater sense of openness. Three large skylites were added to bring natural light to the interior, while indirect fluorescent lighting helps to create peaceful atmosphere for exercise. Gentle curves help delineate programatic functions and lead the clients and trainers through the space. Green materials include cork and bamboo flooring, natural wood counters, and low-voc paints.



Sunstructures Architects

201 East Liberty, Ann Arbor, MI 48104 (734)994-5650